

Clear O₃

OZONE PURE WATER™

FLOW METER

INSTALLATION MANUAL



Signal Words and Symbols Used In This Manual

This Owner's Manual and Installation Guide contains specific precautions and symbols to identify safety-related information. You will find DANGER, CAUTION, WARNING and NOTICE symbols which require special attention. Please read them carefully and follow these precautions as indicated! They will explain how to avoid hazards that may endanger you or persons using or maintaining your pool or spa.



DANGER

DANGER indicates a hazardous situation which, if

not avoided, will result in death or serious injury.



WARNING

WARNING indicates a hazardous situation which, if not avoided,

could result in death or serious injury.



CAUTION

CAUTION indicates a hazardous situation which, if not avoided,

could result in minor or moderate injury.

NOTICE

NOTICE is used to address practices not related to

physical injury.

PLEASE REVIEW THE OWNER'S MANUAL AND INSTALLATION GUIDE IN ITS ENTIRETY AND HEED ALL SAFETY INFORMATION. Failure to follow these instructions and warnings can result in DEATH OR SERIOUS INJURY.



Paramount®

8175 W. Buckeye Rd., Phoenix, AZ 85043

Toll Free: 1.800.621.5886 • Phone: 480.893.7607 • Fax: 480.753.3397

Paramount@1Paramount.com • www.1Paramount.com

US and Foreign patents and patents pending

see www.1paramount.com/support/patent-numbers/

SAFETY INSTRUCTIONS



“IN ACCORDANCE WITH CANADIAN STANDARDS ASSOCIATION'S
STANDARD NO. CAN/CSA - C22.2 NO. 218.1 - M89”,
OZONE GENERATOR
WITH RESPECT TO RISKS OF ELECTRIC SHOCK
FIRE AND MECHANICAL INJURY ONLY
34YZ

IMPORTANT SAFETY INSTRUCTIONS: READ COMPLETELY BEFORE PROCEEDING WITH INSTALLATION. SAVE THESE INSTRUCTIONS

When using this electrical equipment, basic safety precautions should always be followed, including the following:



CAUTION

READ AND FOLLOW ALL INSTRUCTIONS

- Follow all applicable electrical codes.
- A qualified licensed electrician should perform electrical hookup.
- Turn off power at main source before making any electrical connections or servicing the unit.
- Use only liquid-tight flexible nonmetallic conduit for electrical connections.
- A terminal marked G is located inside the supply terminal compartment. To reduce the risk of electric shock, this terminal must be connected to the grounding means provided in the electrical supply service panel with a continuous copper wire equivalent in size to the circuit conductors supplying this equipment.
- At least one lug marked “BONDING LUG” provided on the external surface of the unit. To reduce the risk of electric shock, connect the local common bond grid in the area of the pool or spa to this terminal with an insulated or bare copper conductor not smaller than 6 AWG.



WARNING

- ALWAYS wear safety glasses when using power equipment during the installation process.
 - Install at least 5 ft from pool or spa water using nonmetallic plumbing. Mount ozone generator near pool equipment at least one (1) foot above maximum water level to prevent water from contacting electrical equipment. Install in accordance with the installation instructions.
 - Short-term inhalation of high concentrations of ozone and long-term inhalation of low concentrations of ozone gas can cause serious harmful physiological affects. Do not inhale gas produced by this unit. If installed in an enclosed space make sure to account for adequate ventilation.
 - **UV LIGHT PRODUCED BY THIS UNIT IS HARMFUL TO THE EYES AND MAY CAUSE BLINDNESS. DO NOT LOOK DIRECTLY AT A LIT BULB!**
- NOTICE TO INSTALLER/OWNER:**
- Save these instructions and deliver to pool owner when installation is complete.
 - Lamp contains mercury. Dispose of in accordance with local and state regulations.

MAKING PLUMBING CONNECTIONS



WARNING

Turn off power to the filtration system pump at the main source before making any plumbing connections or changes.

Chart 1 - Check valve installation at the pump pot

| Pump to water level | Check Valve Rating | Part Numbers |
|-----------------------------|--------------------|-----------------|
| -2' to +1' (-60cm to +30cm) | 0.5 lb | 005-402-1250-00 |
| 1' - 2' (30cm - 60cm) | 1.0 lb | 005-402-2505-00 |
| 2' - 3' (60cm - 90cm) | 1.5 lb | 005-402-2502-00 |
| 3' - 4' (90cm - 120cm) | 2.0 lb | 005-402-2506-00 |
| 4' - 8' (120cm - 240cm) | 3.0 lb | 005-401-2503-00 |

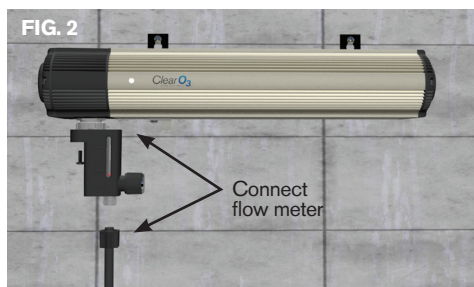
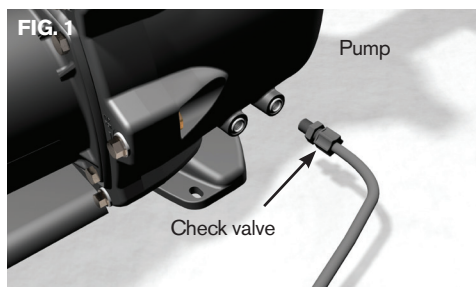

PUMP STRAINER POT INSTALLATION

1. Check pump elevation above water level. Refer to (Chart 1) for proper check valve selection. The 0.5 lb valve comes standard with Clear O3 and others are available to order separately.
2. Remove strainer pot plug.
3. Wrap the check valve four times with teflon tape and install into the strainer pot plug-hole. Add more tape if valve does not seal. (Fig. 1)
4. Install the combination needle valve flow meter on the bottom of the Clear O3 unit. (Fig. 2)
5. Install 3/8" OD x 1/4" ID tubing to compression end of check valve. (Fig. 1). The tubing also needs to connect to the bottom of the flow meter (Fig. 2).

PRE-PUMP STANDPIPE INSTALLATION

1. Cut cap off standpipe.
2. Glue a 3/4" elbow and a 3/4" x 1/4" NPT reducer bushing on end of standpipe.
3. Install the threaded end of the check valve included in the reducer bushing. (Fig. 3)
4. Install 3/8" OD x 1/4" ID tubing to valve using the compression nut. (Fig. 3)
5. Lay the 3/8 tubing along desired route to the compression fitting on the combination needle valve flow meter on the Clear O3 unit.
6. Connect the tubing to the compression fitting. (Fig. 2)
7. Use the provided wires ties to tie the loose tubing to the conduit or plumbing. (Fig. 4)

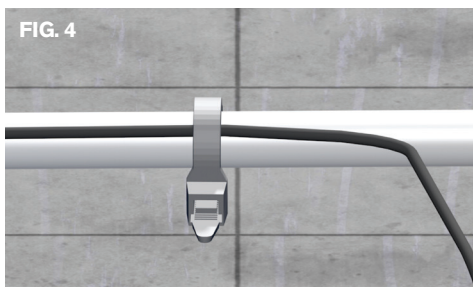
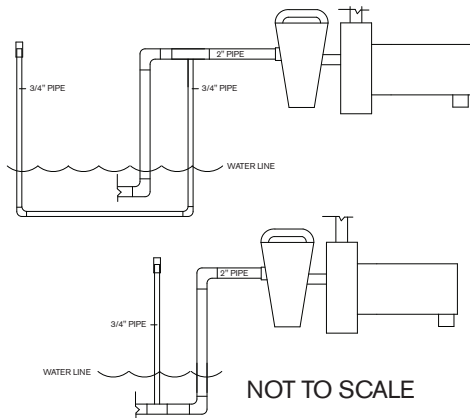

SETTING AIR FLOW

1. Clean filter and pump basket before setting airflow.
2. Turn the knob on the needle valve/flow meter clockwise to close valve completely.
3. Turn the power on to the pump and set the pump to the highest speed it is intended to run.
4. Adjust flow meter by turning the knob counter clockwise until the ball reads at the top of the range.

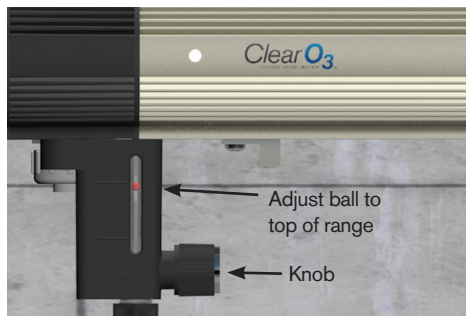

Note: From time to time condensation may collect in the flow meter, especially in moist climates or following a rain storm. The moisture may cause the orange ball to become stuck. The flow meter is not broken. The water will eventually dry up and the ball will begin to float again. To check draw to the pump look for air bubbles entering the pump pot.

IMPORTANT NOTES REGARDING THE FLOW METER:

1. IF THE PUMP THAT THE CLEAR O3 UNIT IS INSTALLED ON IS A PUMP RUNNING A PARAMOUNT IN-FLOOR SYSTEM, lock the water valve on pause (the pause control is located on top of the Paramount water valve) when the valve is switching ports and therefore at it's maximum flow. Set the flow meter so the ball is on the upper line of the "normal" range.
2. WHEN USING MULTIPLE SPEED PUMPS, SET THE FLOW METER WITH THE PUMP RUNNING ON THE HIGHEST SPEED THAT WILL BE USED.
3. The Clear O3 flow meter is very sensitive and the red ball may drop down below the 'normal' marker after it has been set. If this happens on your unit, please be aware that this is normal. The flow meter will still deliver the proper amount of ozone as long as the blue light is on. You do not need to reset the flow meter until after you clean your filter.