

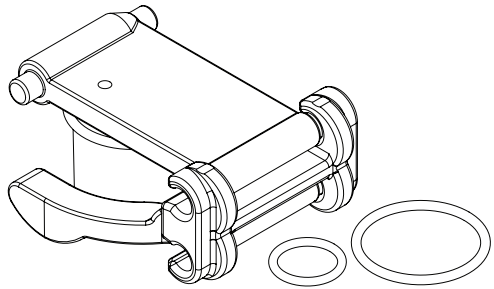

## FLOAT ASSEMBLY SEAL REPLACEMENT MANUAL



8175 W. Buckeye Rd., Phoenix, AZ 85043

Toll Free: 1.800.621.5886 • Phone: 480.893.7607 • Fax: 480.753.3397

Paramount@1Paramount.com • [www.1Paramount.com](http://www.1Paramount.com)

US and Foreign patents and patents pending

see [www.1paramount.com/support/patent-numbers/](http://www.1paramount.com/support/patent-numbers/)

## Paralevel float assembly kit

005-762-2932-00

Includes:

- Level assembly
- White o-ring
- Black o-ring - replace if necessary

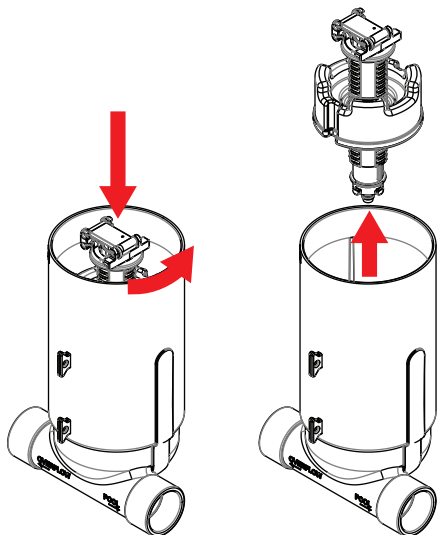
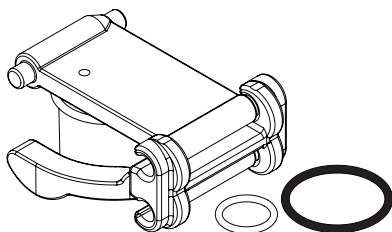

1. Turn off the water supply to the Paralevel. Remove the Paralevel float assembly by grasping the top of the float assembly and while pushing down turn the assembly counter clockwise a quarter turn. The float assembly should then pull out.

2. There is a white o-ring seal at the bottom end of the float assembly. Peel off to remove. Slide a new white o-ring over the end and into the groove to replace.

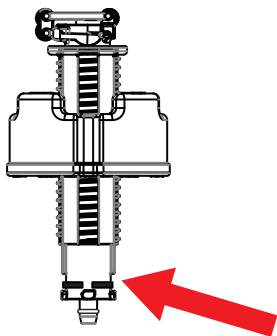

3. Next spread the retainer ring at the bottom end to remove it from the groove and slide it to the bottom of the shaft.

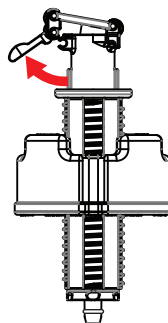

4. At the top end of the float assembly grab the forked link lever and pivot it down and back gently until it pulls free from the snap swivel point.

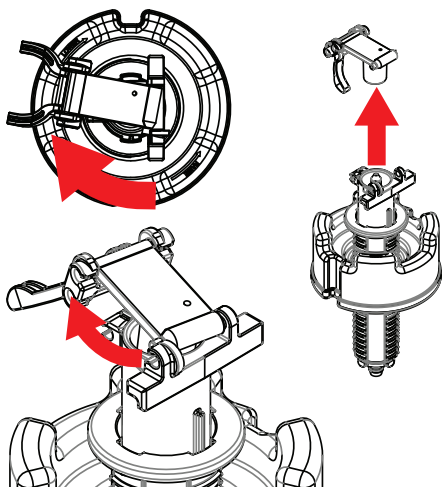

5. Grab the top cap seal arm and twist away from the snap swivel that has the opening in it. Pull the top cap seal arm out of the top of the float assembly.
6. Reinstall the new components by reversing this process.

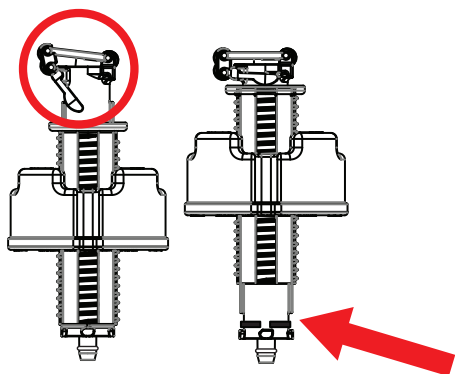

7. Confirm the new seal lever assembly moves freely. Then push the retainer ring on the bottom of the assembly back into the groove.

8. Re-installing float assembly
  - Start with float 1/4 down from the top on sleeve adjuster
  - Position the end of the riser tube with the o-ring inside the opening at the top of the nut retainer.
  - Turn the riser tube clockwise and wiggle until it drops into the nut retainer. Too much downward pressure before it sets into the opening of the nut retainer will cause the float assembly to hang up.
  - Press down on the top of the riser tube and twist clockwise 1/4 turn or until it stops.

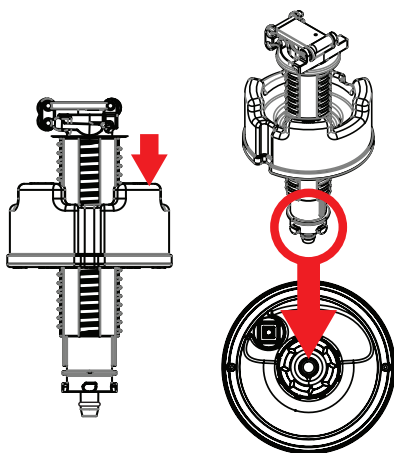

Continued on next page

## 9. Adjusting water level

Adjustment procedure (standard 3" waterline below beam).

- Adjust the pool water level to the desired point on the tile line.
- Turn on water supply at source fully.
- Start with the float high and the leveler allowing water to flow.
- Turn the float clockwise 1/2 turns at a time until the Paralevel shuts off.

