



Ultra UV₂TM

ULTIMATE UV WATER SANITIZER

Ballast Replacement Instructions



Pool, Spa & Pond
Water Sanitizer 4BUJ1



EPA Registered
#084221-AZ-001

SAVE THESE INSTRUCTIONS



8175 W. Buckeye Rd., Phoenix, AZ 85043

Toll Free: 1.800.621.5886 • Phone: 480.893.7607 • Fax: 480.753.3397

Paramount@1Paramount.com • www.1Paramount.com

US and Foreign patents and patents pending

see www.1paramount.com/support/patent-numbers/

Signal Words and Symbols Used In This Manual

This installation guide contains specific precautions and symbols to identify safety-related information. You will find DANGER, CAUTION, WARNING and NOTICE symbols which require special attention. Please read them carefully and follow these precautions as indicated! They will explain how to avoid hazards that may endanger you or persons using or maintaining your pool or spa.



DANGER

DANGER indicates a hazardous situation which, if not avoided, will result in death or serious injury.



WARNING

WARNING indicates a hazardous situation which, if not avoided, could result in death or serious injury.



CAUTION

CAUTION indicates a hazardous situation which, if not avoided, could result in minor or moderate injury.

NOTICE

NOTICE is used to address practices not related to physical injury.

PLEASE REVIEW THE INSTALLATION GUIDE IN ITS ENTIRETY AND HEED ALL SAFETY INFORMATION. Failure to follow these instructions and warnings can result in DEATH OR SERIOUS INJURY.



DANGER

IMPORTANT SAFETY INSTRUCTIONS: READ COMPLETELY BEFORE PROCEEDING.

When using this electrical equipment, basic safety precautions should always be followed, including the following:

WARNING:

- Follow all applicable electrical codes.
- Turn off power at main source before making any electrical connections or servicing the unit.
- To reduce the risk of electric shock, injury or death disconnect unit from power supply
- Follow the instructions or risk of serious injury or death could occur!



DANGER

RISK OF INJURY

- A) REPLACE DAMAGED CORD IMMEDIATELY.
- B) DO NOT BURY CORD.
- C) CONNECT TO A GROUNDED, GROUNDING TYPE RECEPTACLE ONLY.



WARNING

UV EXPOSURE & PROTECTION:

UV-A and UV-B radiation can have adverse short and long term effects on the eyes and skin. Never look directly at a UV lamp that is connected to a power source. Avoid UV skin exposure at all times. To reduce the risk of injury, do not permit children to use this product unless they are closely supervised at all times. Risk of electric shock. Install at least 5 feet (1.5m) from inside wall of pool, hot tub or spa using nonmetallic plumbing. This product shall only be connected to a power supply receptacle protected by a ground fault circuit interrupter.



- Turn off the power supply to the Ultra UV2 unit. Turn off power to the pool pump.
Disconnect the input power to the installed Ultra UV2:
- For 120v units unplug the supply cord from the GFCI.
 - For 230v units disconnect the incoming power by switching the circuit breaker off.

Ultra UV2 Universal Ballast

Replacement Kit #005-422-9030-00

Includes:

- (A) ballast
- (B) input bulkhead wiring harness
- (C) 2 lamp wiring harness
- (D) 1 lamp wiring harness
- (E) double neutral wire to terminal
- (F) single neutral wire to terminal
- (G) single pressure switch wire
- (H) double pressure switch wire
- (I) ground wires
- (J) connector tool*

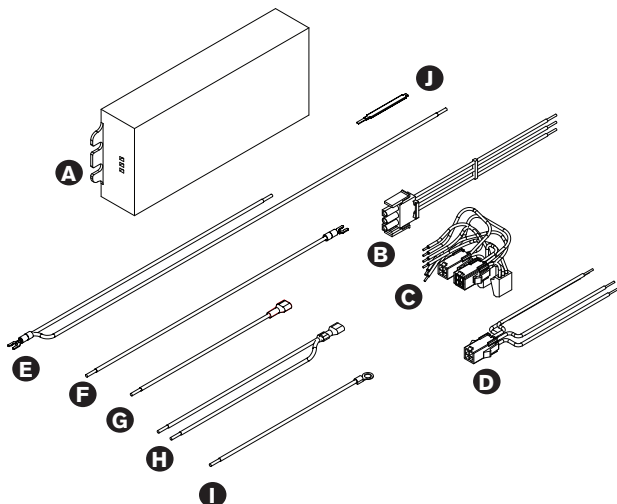

IMPORTANT NOTES

The Ultra UV2 includes ballast input wires for several build configurations. Not all wires included in kit will be used.

*If wires need to be removed from the ballast use connector tool (if supplied in kit), slotted screwdriver or paper clip. Insert tool into slot and pull wire from ballast.

Remove the bonnet screws & lift bonnet from tank and proceed to replacing ballasts.

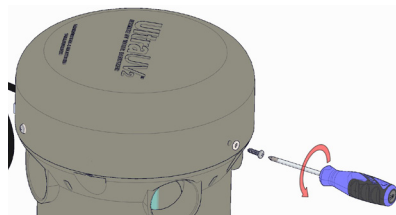

IDENTIFY THE CONFIGURATION OF THE ULTRA UV2 UNIT

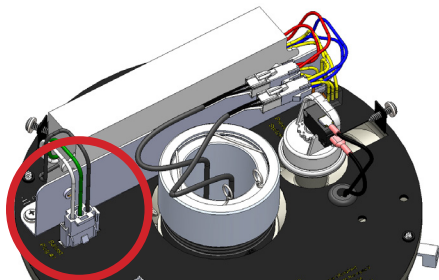

ULTRA UV CONFIGURATION 1
BULKHEAD CONNECTOR (UNITS BUILT
BETWEEN APR. 2014 TO NOV. 2018
(PAGE 3)

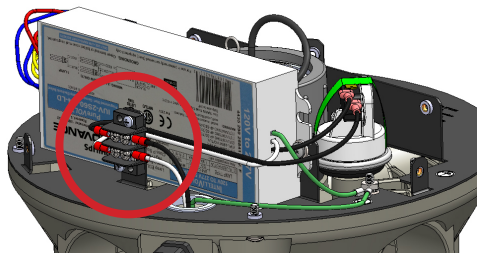

ULTRA UV CONFIGURATION 2
TERMINAL BLOCK (UNITS BUILT AFTER NOV.
2018 (PAGE 4)

CONFIGURATION 1 BALLAST REPLACEMENT

NOTE: IF REPLACING 2 BALLASTS REPEAT STEPS 1-7 FOR SECOND BALLAST

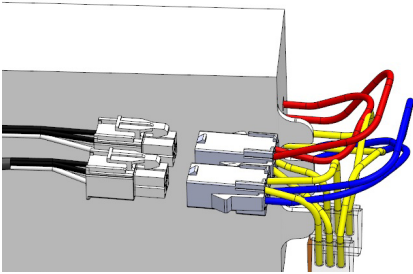

1. Disconnect all lamps by pressing the release tabs on connectors and gently pulling apart.

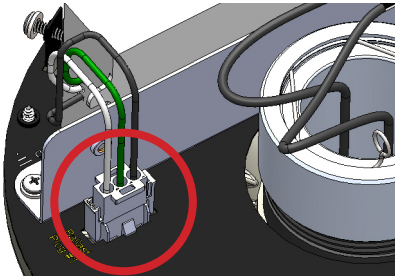

2. Disconnect the bulkhead connector(s).

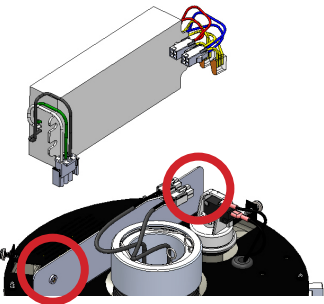

3. Remove the 2 mounting screws and lift the ballast from the unit. Set aside for disposal or return.

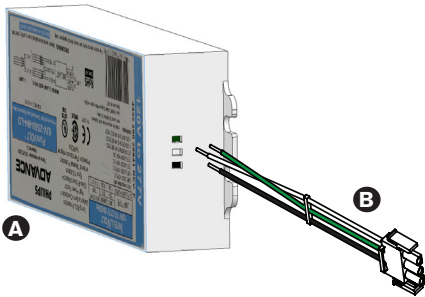

4. From the replacement ballast kit, connect all the color wires of the bulkhead connector (B) to the corresponding color inputs in the ballast(s)(A).

NOTE: Use only the side terminals.

CHOOSE THE CORRECT LAMP CONNECTOR HARNESS

Populate the output side of the new ballast with the correct lamp connector harness wires: Connect all the color wires to the corresponding color inputs in the ballasts.

NOTE: Use only the side terminals.

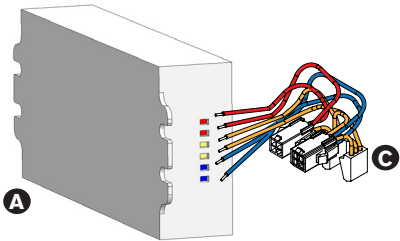

2 Lamp unit

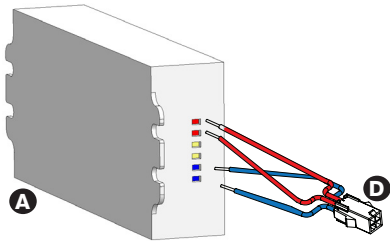

1 Lamp unit

5. Re-attach the new ballast assembly to the mounting plate with the bulkhead connectors on the same side.
6. Attach the bulkhead connector(s).
7. Attach the lamp connector harness(es) to the lamp wires.
8. Install the bonnet with the 3 screws.
9. Turn on power to the UV unit and pump & test for system functionality.

CONFIGURATION 2: SINGLE BALLAST REMOVAL

NOTE: IF REMOVING 2 BALLASTS REPEAT STEPS 1-6 FOR SECOND BALLAST (PAGE 6)

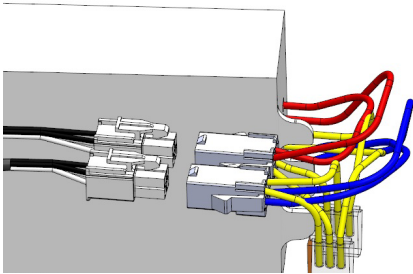

1. Disconnect all lamps by pressing the release tab(s) on connector(s) and gently pulling apart.

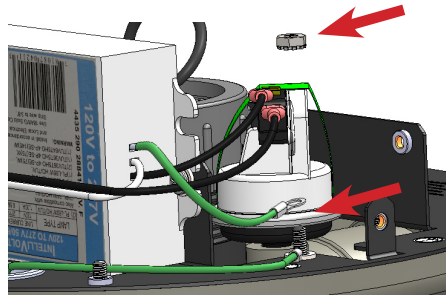

2. Remove the nut(s) from the grounding post(s). Remove the ballast ground wire(s) ring terminal from the same post(s).

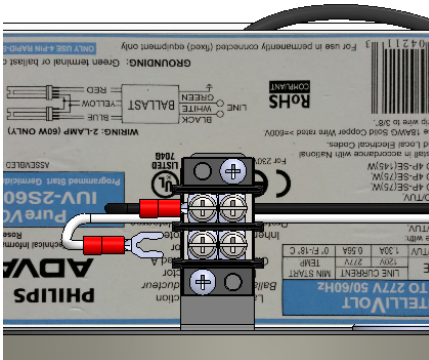

3. Loosen the lower screw on left side of terminal block, then gently remove the white wire.

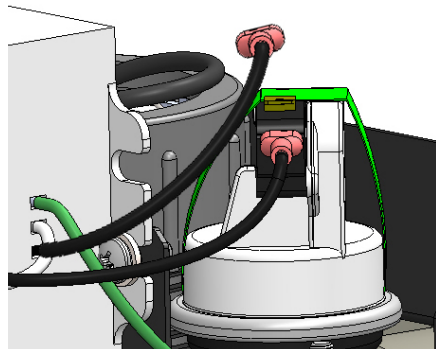

4. Remove the black ballast wire(s) from the pressure switch terminal.

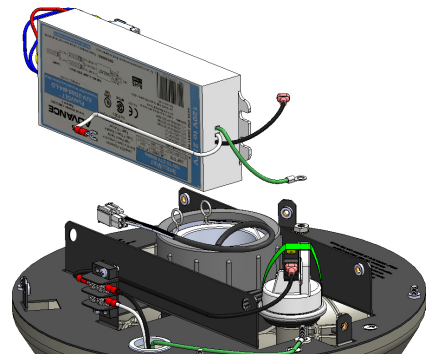

5. Remove the mounting screws and lift the ballast(s) from the unit.

CONFIGURATION 2: SINGLE BALLAST INSTALL

Populate the output side of the new ballast with the correct lamp connector harness wires: Connect all the color wires to the corresponding color inputs in the ballasts.

Please note that the side terminal, not back side terminal, should be used.

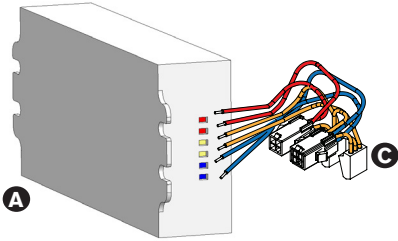

2 Lamp unit

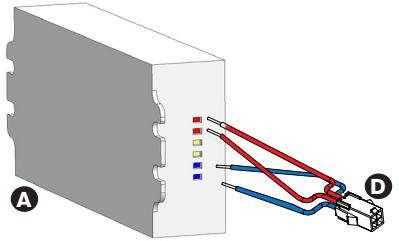

1 Lamp unit

SINGLE BALLAST WIRING

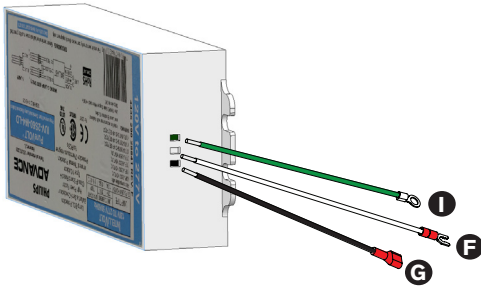

6. Using the individual wires (I, F, G) connect the color wires to the corresponding color inputs in the ballast (H).

NOTE: Use only the side terminals.

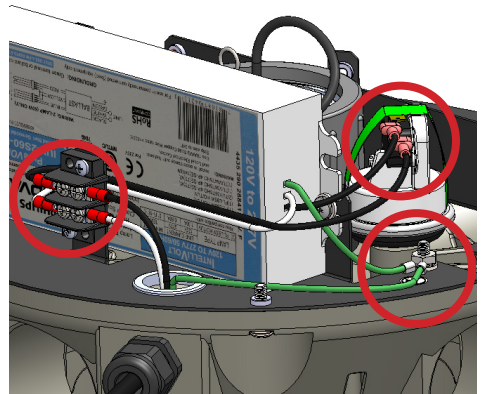

7. Mount the new ballast onto the mounting plate.
Reattach the white wire to the left side of the terminal block, the ground green wire to the grounding post and the black wire to the pressure switch.

8. Attach the lamp connector harness(es) to the lamp wires.
9. Install the bonnet with the 3 screws.
10. Turn on power to the UV unit and pump & test for system functionality.

CONFIGURATION 2: 2 BALLASTS INSTALL

Populate the output side of the new ballast with the correct lamp connector harness wires: Connect all the color wires to the corresponding color inputs in the ballasts.

Please note that the side terminal, not back side terminal, should be used.

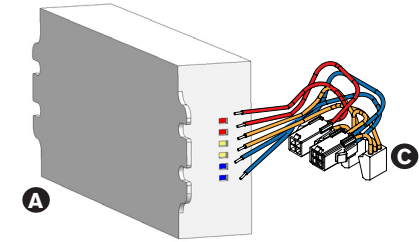

2 Lamp unit

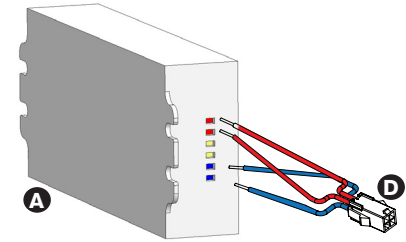

1 Lamp unit

You will need to use some of the additional wires included with the kit.

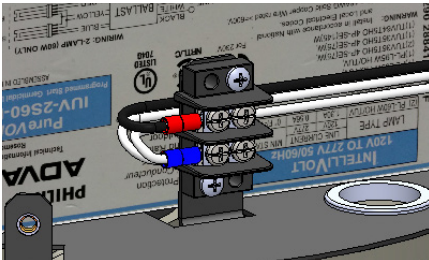
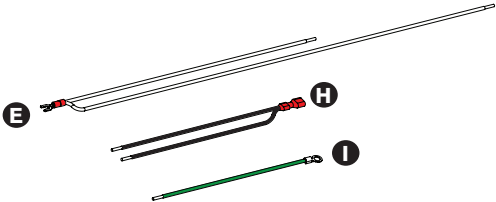

- 1. Install the supplied double white wire (E) to the terminal block. Tuck wires behind terminal block.

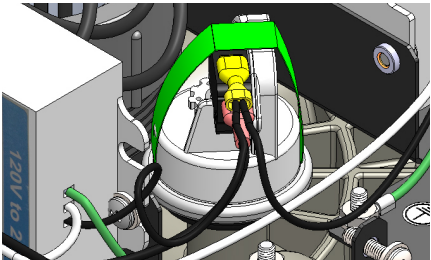

- 2. Connect double black wire (H) to top terminal of pressure switch.

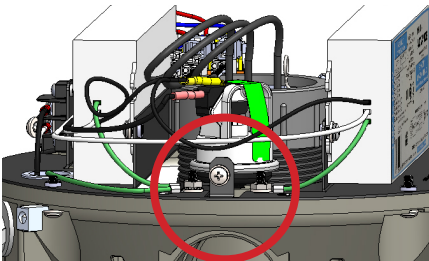

- 3. Install both green ground wires (I), connect it to the right ground post. Make sure the flat washer is underneath the ring terminal of the green wire.

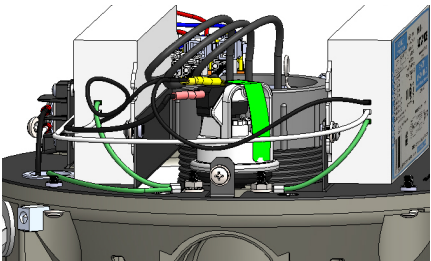

- 4. Connect all the color wires to the corresponding color inputs in the ballasts.

- 5. Attach the lamp connector harness(es) to the lamp wires.
- 6. Install the bonnet with the 3 screws.
- 7. Turn on power to the UV unit and pump & test for system functionality.

