



3" LED NICHE LIGHT



CONCRETE POOLS

INSTALLATION & OWNER'S MANUAL

Powered by:
Paramount™
Pool Life. Simplified.

CONTENTS

READ THIS FIRST	3
TOOLS REQUIRED	4
PRODUCT SUPPORT & INFORMATION	4
INCLUDED PARTS	5
FINISHED INSTALLATION	6
INSTALLATION INSTRUCTIONS	7
LIGHT ASSEMBLY	16
LIGHT REMOVAL	17
MULTI-COLOR OPERATION	18
KEY DIMENSIONS	21
TROUBLESHOOTING	22
ELECTRICAL GROUNDING & FCC COMPLIANCE STATEMENT	23



NOTICE

**FRESH WATER USE ONLY
HORIZONTAL MOUNT ONLY
NOT INTENDED FOR OPERATION OUT OF WATER**

**FOR SUPPLY CONNECTION, USE ONLY AN ISOLATING LOW VOLTAGE POWER
SUPPLY WITH UNGROUNDED OUTPUT, EVALUATED FOR SWIMMING POOL USE**

READ THIS FIRST

Congratulations on your purchase of a **ParaGlo** underwater lighting system.

All **ParaGlo** lights are manufactured by Spa Electrics in Australia from only the highest quality materials and exclusively distributed through Paramount Pool & Spa Systems, USA.

BEFORE YOU START:

- **ParaGlo** cables can be shortened to suit individual installation requirements. Spa Electrics recommends all cabling is protected by conduit and that a junction box (or similar) is incorporated into pool cabling design to avoid siphoning.
- Ensure that the lighting system is installed by a qualified person (e.g. registered pool builder and/or licensed electrician), in accordance with the most current edition and/or amendment of current NEC wiring code.
- For safe and proper installation, ensure that only those parts supplied with the system are used.
- Maximum installation depth for the **ParaGlo 3"** light is 1.2ft (14") below water line (to top of light).
- The **ParaGlo 3"** light must be correctly installed in or on the wall of the pool with the top of the lens no less than **4"** below the nominal water level.
- All lights should be mounted in a location that is easily accessible without the need for entering or lowering the pool water.
- 20" cable has been supplied pre-assembled within niche assembly, and must remain stored within the Niche to ensure the light can be accessed above the waterline. [Maximum cable within niche = 24" (18AWG & 16AWG). See Page 16 for more information].

CLEANING

- Only use warm water and a soft brush or cloth to clean **ParaGlo** lights. **DO NOT** use detergents or spirits as this can damage the light and void your warranty.

USE

- **DO NOT** operate light unless completely submerged in water.
- Operating the light for at least 15 minutes every week is advised (all year round).
- **ParaGlo** lights are suited for both domestic and commercial installations and can be operated continuously (24/7) if required.
- Temperature range for installation, operation and servicing: +32°F ~ +104°F (0°C ~ +40°C)



IMPORTANT NOTE

The ParaGlo light must only be used with a UL listed 12V AC Class 2 power supply or a power source intended for swimming pool use (not included).

Minimum power source wattage requirement - 15 Watts per light.

- DO NOT use electronic or switch-mode power supplies with **ParaGlo** lights. These power supplies will damage the light and void your product warranty.
- Pool chemicals & PH levels: Due to the corrosive nature of unbalanced pool chemicals, Spa Electrics strongly recommend that your pool water is balanced prior to installing your pool lights or any plastic or stainless steel components, and tested weekly to maintain these levels. pH levels should be maintained between 7.2 – 7.6 at all times to ensure the longevity of these components.
 - > Failure to do so can result in chemical damage to the light housing and pool fittings, including stainless steel components.
 - > Please note: Lights or components found to have excessive chemical damage will not be covered under our manufacturer's warranty policy.
- This light contains no user-serviceable parts; opening the light will void the product warranty.

TOOLS REQUIRED

- No. 2 Phillips screwdriver
- Flat-blade screw driver (for light removal)



IMPORTANT NOTES

- The use of power tools during installation is **not** recommended as these devices can cause faults and damage to light components.
- All installation steps should be carried out with manual tools only.
- The enclosed images are for illustrative purposes only. Appearances of parts and assemblies may vary from the enclosed illustrations.
- Please contact your reseller if you have any questions regarding the correct installation of this product.



WINTERIZATION

- It is recommended to remove Paraglo lights in areas prone to hard freezing below 4".
- Lights should be disconnected from the power cable via the plug top on the rear of the light.
- The RED plug cover supplied must be fitted to the plug top prior to reinstalling cable into niche for winter.
- Consult your local pool professional for complete pool winterization process.

Please Note: Damage due to hard freezing is not covered under the manufacturer's warranty policy.

PRODUCT SUPPORT & INFORMATION

Phone: **TOLL FREE** 1800 621 5886

Email: paramount@1paramount.com

Web: www.1paramount.com

INCLUDED PARTS

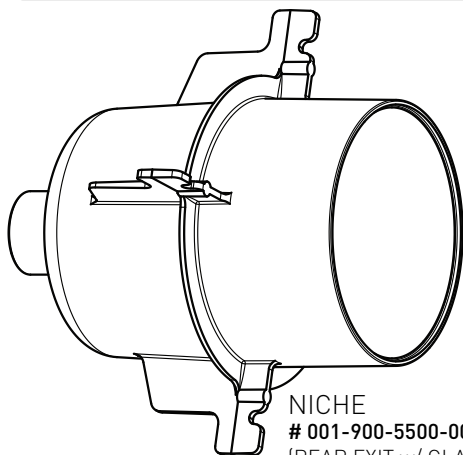

NICHE
001-900-5500-00
(REAR EXIT w/ GLAND)

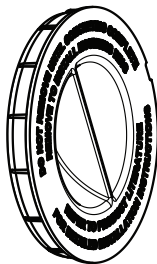

PROTECTIVE
CAP

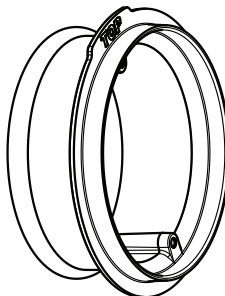

MOUNTING RING
001-900-5400-00

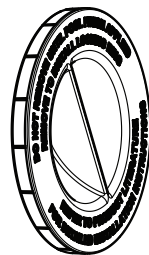

PROTECTIVE
CAP

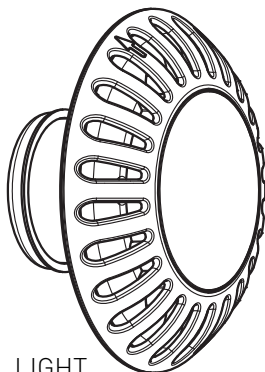

LIGHT

PART # & LED COLORS:

- # 001-900-5000-05 = BLUE
- # 001-900-5100-01 = WHITE 4000K
- # 001-900-5200-00 = MULTI-COLOR
- # 001-900-5300-00 = Pentair / Zodiac Compatible



1x WARRANTY CARD



1x INSTALLATION MANUAL
001-900-5900-00

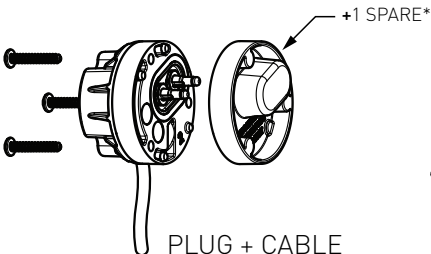

PLUG + CABLE

80ft = # 001-900-5600-00

100ft = # 001-900-5700-00

150ft = # 001-900-5800-00

* 1 SPARE TERMINAL COVER PROVIDED
FOR WINTERIZATION (SEE PAGE 4)

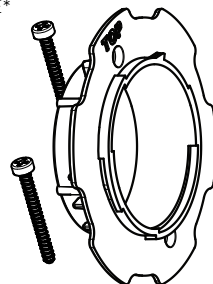

LOCKING RING

UL LISTING

NICHE	# EMC 008LR US
MOUNTING RING	# EMC 009LM US
LIGHT (Blue)	# EMC BL US
LIGHT (White)	# EMC W4 US
LIGHT (Multi)	# EMC MC US
LIGHT (P / Z*)	# EMC MCP US
PLUG & CABLE (80ft)	# EMP 18AWG 80 US
PLUG & CABLE (100ft)	# EMP 18 AWG 100 US
PLUG & CABLE	# EMP 16AWG 150 US
LOCKING RING	# EMC 009LL US



REQUIRED PART (NOT INCLUDED)

UL LISTED 12V AC CLASS 2 POWER SUPPLY OR POWER SOURCE INTENDED FOR SWIMMING POOL USE.

Minimum power source wattage requirement - 15 Watts per light

Spa Electrics recommends "INTERMATIC PX" safety transformers for use with ParaGlo 3" lights

FINISHED INSTALLATION

STANDARD WALL MOUNTING

Depending on your installation requirements, conduits may run to a common junction box or return directly to the power supply. In either case, it is imperative that the conduit extends above the water level of the pool at some point in order to prevent siphoning.

NOTE: Conduit should contain a draw-wire to allow easy installation of power cable

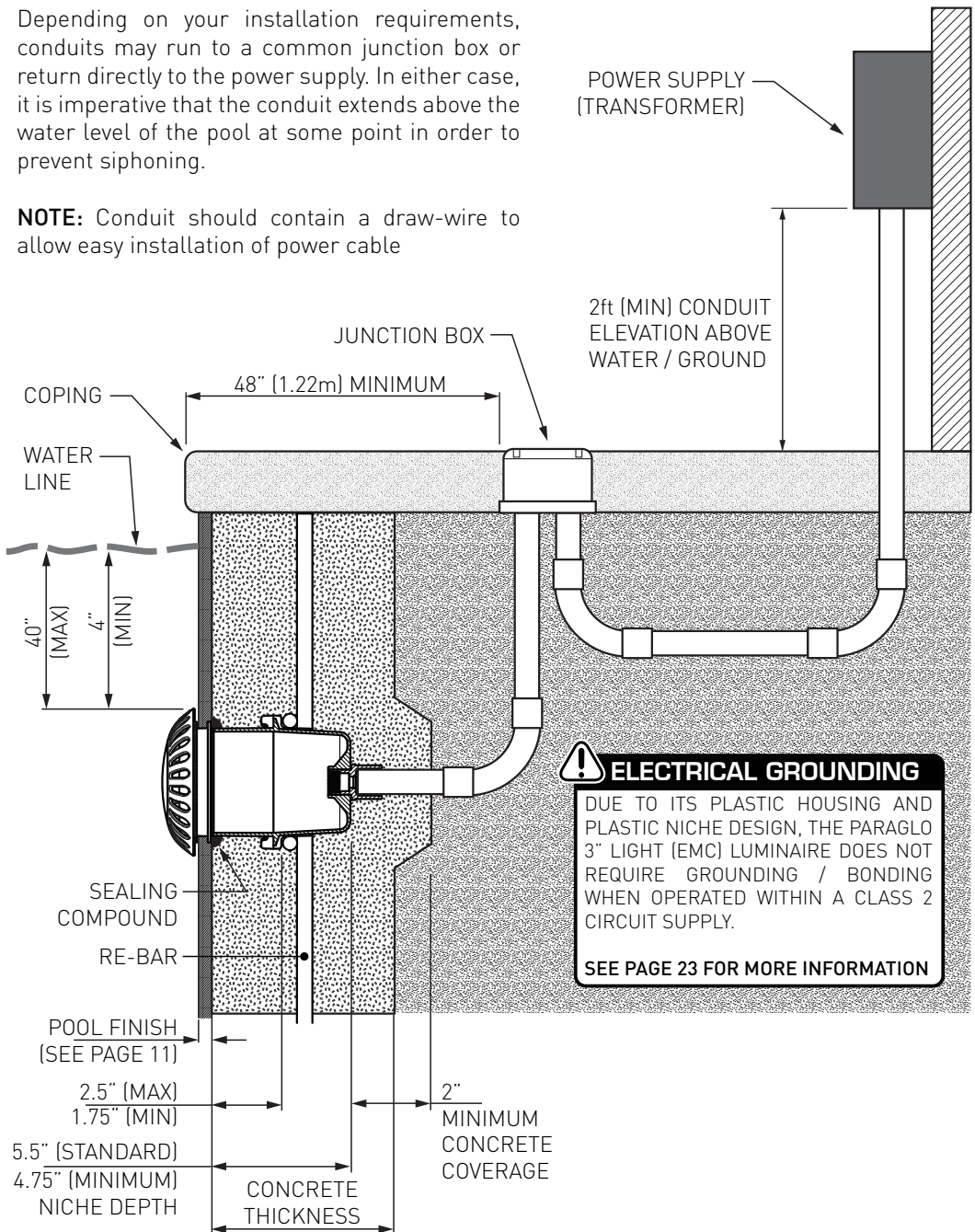

INSTALLATION

1

NICHE & CONDUIT INSTALLATION

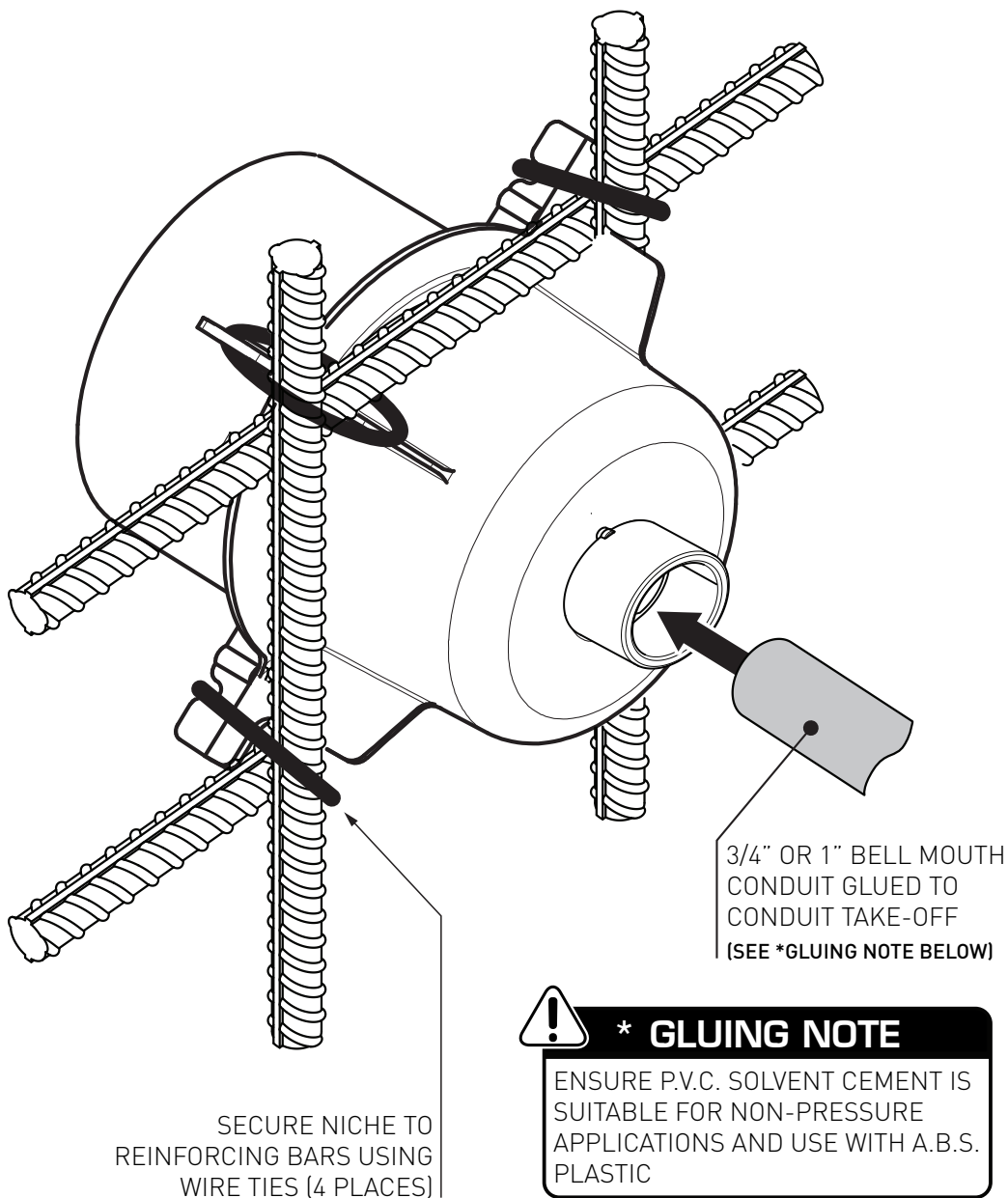

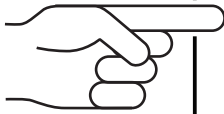
**NOTE**

SCALLOP
CONCRETE
AROUND NICHE
PERIMETER
AND FILL WITH
SEALING
COMPOUND*

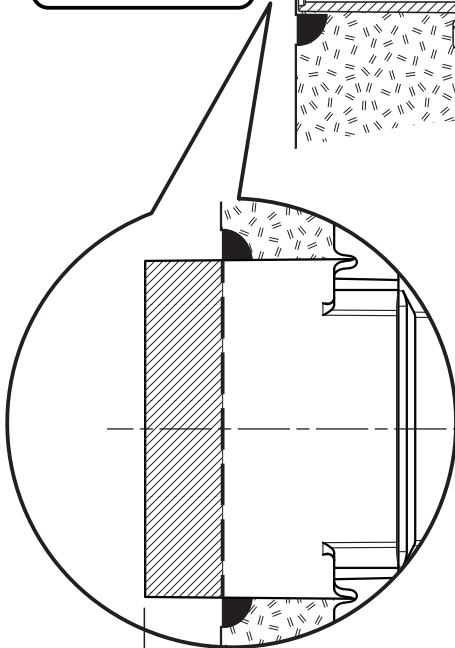
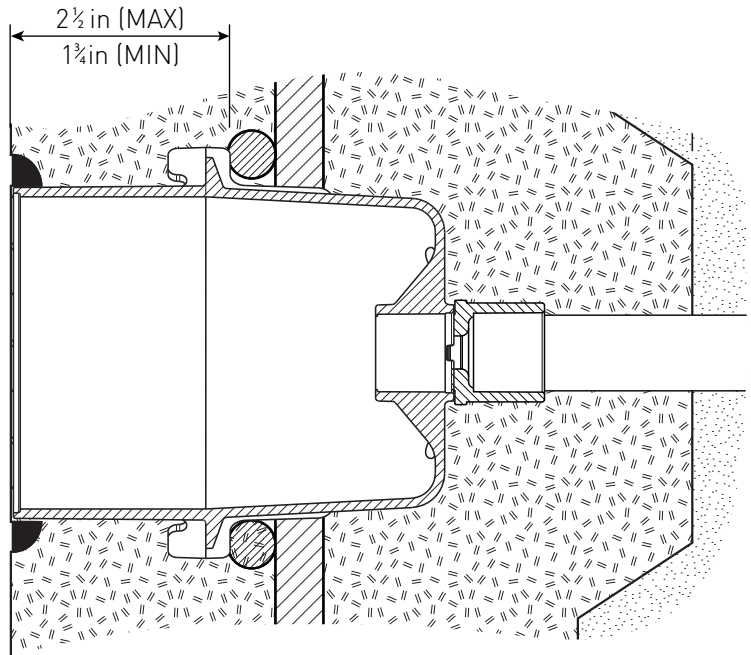

$\frac{3}{4}$ in
(MAX)

NICHE PROTRUDING?

NICHE CAN BE TRIMMED A
MAXIMUM OF $\frac{3}{4}$ in IF IT
PROTRUDES FORWARD OF
FINISHED CONCRETE SURFACE

*** SEALING NOTES**

SEALING COMPOUND OR HYDRAULIC CEMENT REQUIRED TO PREVENT WATER EGRESS THROUGH POOL WALL.

ENSURE NICHE RIM IS CLEAN, DRY AND FREE OF DEBRIS PRIOR TO APPLICATION OF SEALING COMPOUND.

ENSURE SEALING COMPOUND IS SUITABLE FOR USE WITH A.B.S. PLASTIC

3

INSTALL CABLE & PLUG INTO NICHE

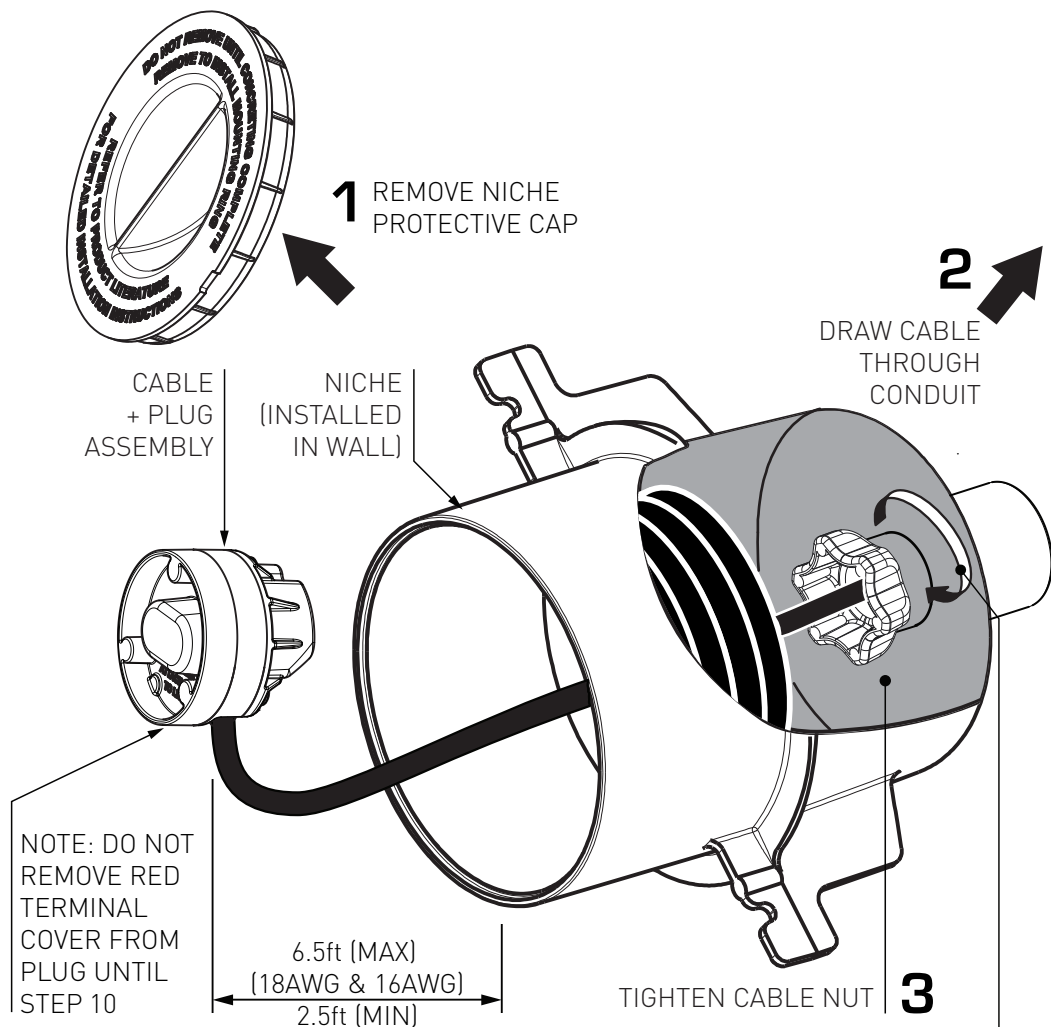

NOTES

- ENSURE CABLE GLAND IS ASSEMBLED AS SHOWN.
- PRIMARY SEALING POINT SHOULD BE VIA CONDUIT WITH AIR LOOP
- CABLE-GLAND COMPONENTS MAY BE OMITTED PROVIDED CONDUITS EXTEND ABOVE WATERLINE TO PREVENT SIPHONING (SEE PAGE 6)

RUBBER GROMMET

PLASTIC WASHER

CABLE NUT

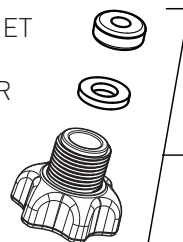

4

INSTALL MOUNTING RING INTO NICHE



NOTE

ENSURE "TOP" IS POSITIONED CORRECTLY

2

APPLY P.V.C. SOLVENT CEMENT TO MOUNTING RING
(SEE * GLUING NOTE BELOW)

1

COIL PLUG & CABLE INSIDE NICHE

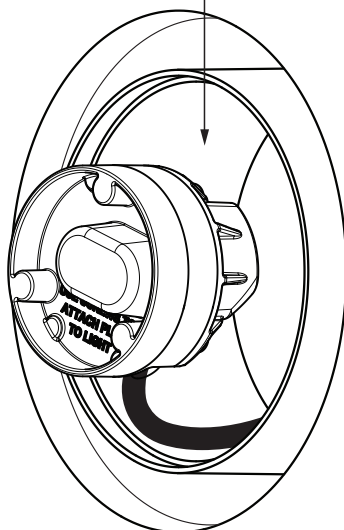
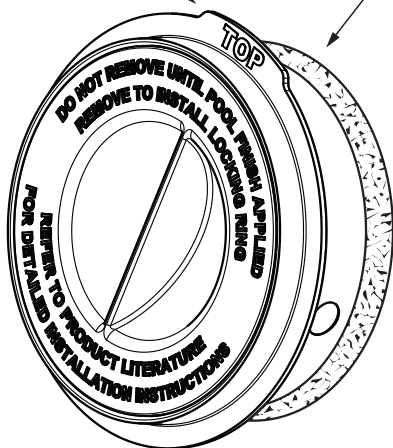

3

FIRMLY PUSH MOUNTING RING INTO NICHE



NOTE

ENSURE PROTECTIVE CAP REMAINS IN MOUNTING RING (UNTIL STEP 7)



* GLUING NOTE

ENSURE P.V.C. SOLVENT CEMENT IS SUITABLE FOR NON-PRESSURE APPLICATIONS AND USE WITH A.B.S. PLASTIC

5

APPLY POOL FINISH



NOTE

PROTECTIVE CAP MUST REMAIN IN MOUNTING RING DURING PLASTERING / TILING

USE FRONT EDGE OF MOUNTING RING AS GUIDE
FOR MINIMUM POOL-FINISH THICKNESS

$\frac{3}{4}$ " MAXIMUM
THICKNESS

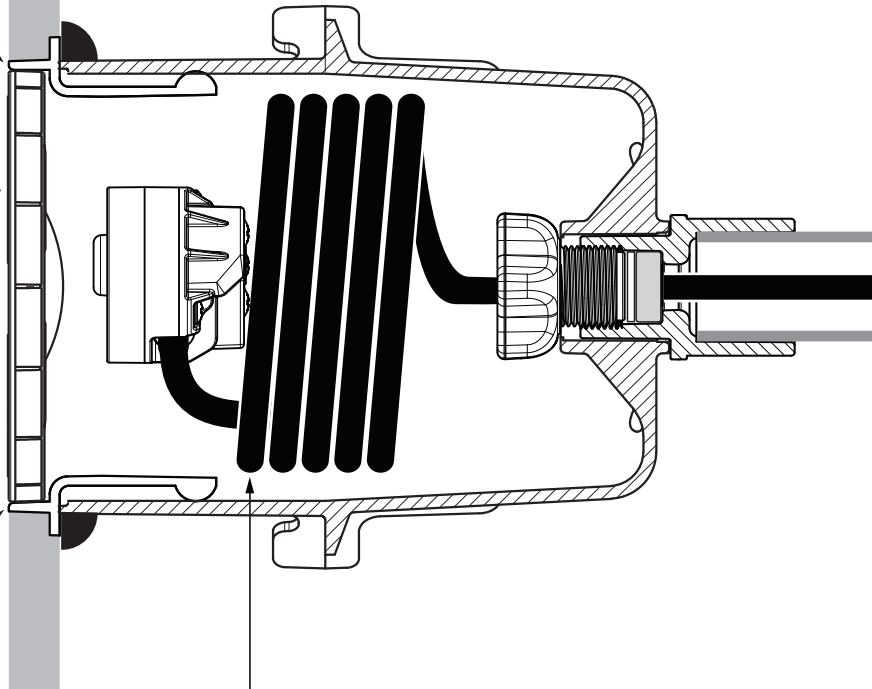

NOTE

DO NOT TRIM
FRONT EDGE OF
MOUNTING RING

CABLE COILED
WITHIN NICHE

6

REMOVE LOCKING RING

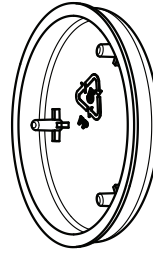
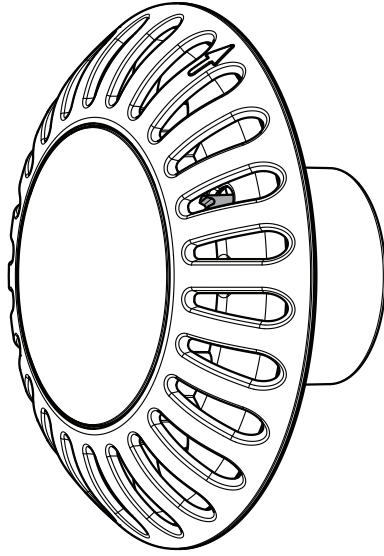

1 REMOVE
PROTECTIVE
CAP

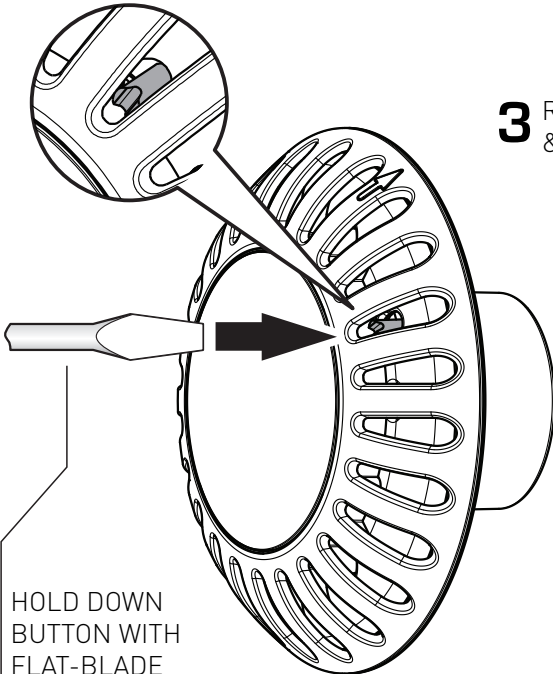

2

HOLD DOWN
BUTTON WITH
FLAT-BLADE

3 ROTATE COUNTER-CLOCKWISE
& RELEASE LOCKING RING

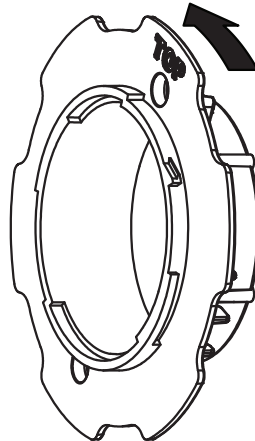

4

REMOVE
LOCKING
RING

- 1** REMOVE MOUNTING SCREWS FROM REAR OF LOCKING RING.

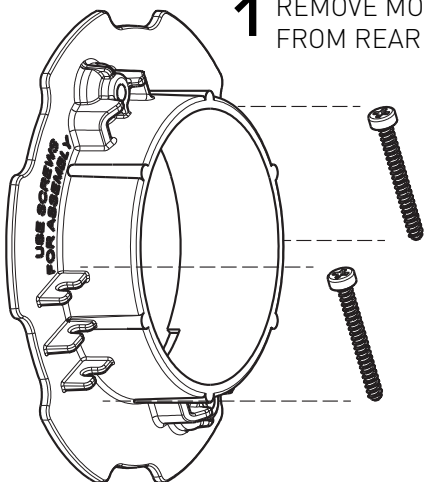

- 2** REMOVE PROTECTIVE CAP FROM MOUNTING RING

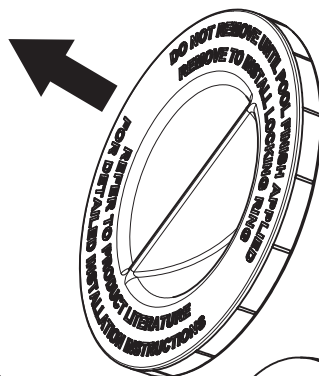

- 3** PULL PLUG + CABLE THROUGH LOCKING RING

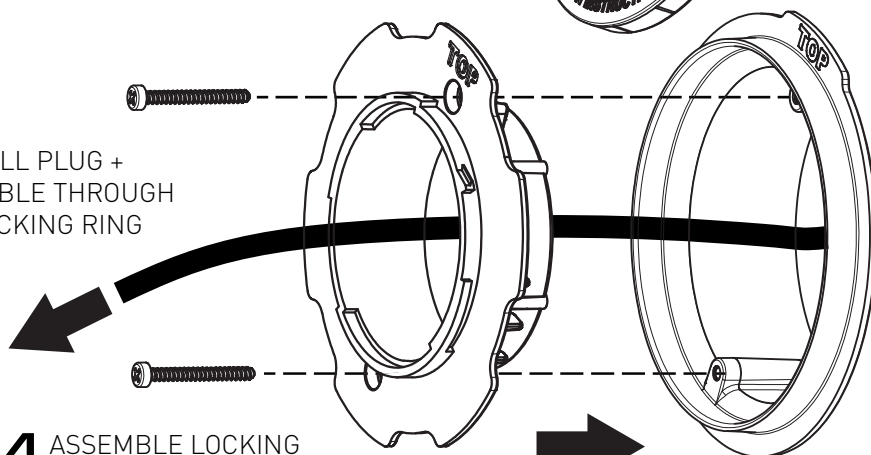

- 4** ASSEMBLE LOCKING RING WITH MOUNTING RING USING MOUNTING SCREWS PROVIDED.

8

REMOVE TERMINAL COVER

REMOVE TERMINAL COVER FROM PLUG USING PHILLIPS-HEAD (NO.2) SCREW-DRIVER

NOTE
ENSURE SEAL IS SEATED FLAT IN PLUG BASE

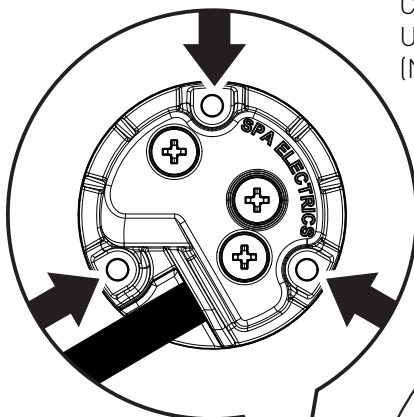

ENSURE SEAL IS SEATED FLAT IN PLUG BASE

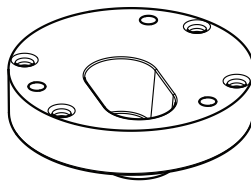
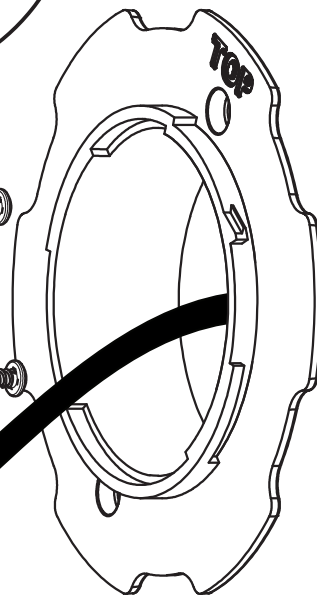
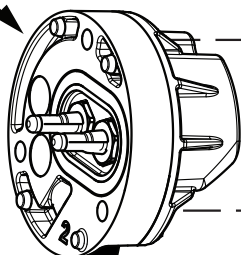

TERMINAL COVER

NOTE
DO NOT REMOVE TERMINAL COVER UNDERWATER

WINTERIZATION
RETAIN TERMINAL COVER FOR WINTERIZATION. SEE PAGE 4 FOR DETAILS

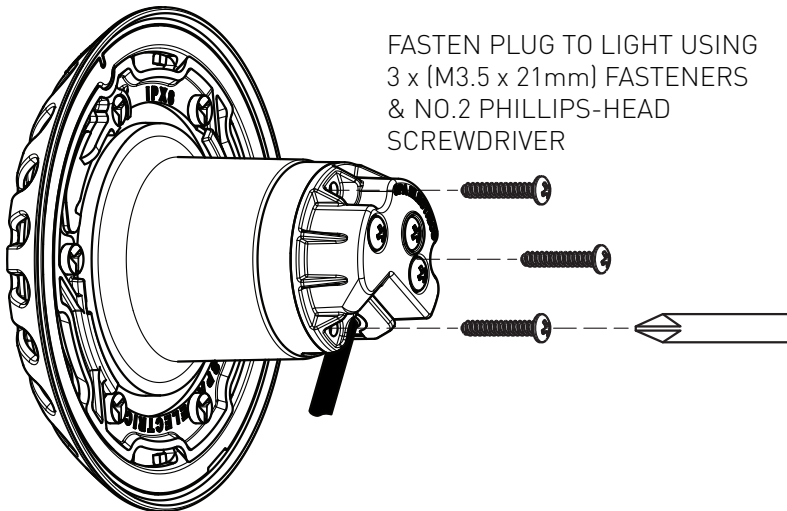
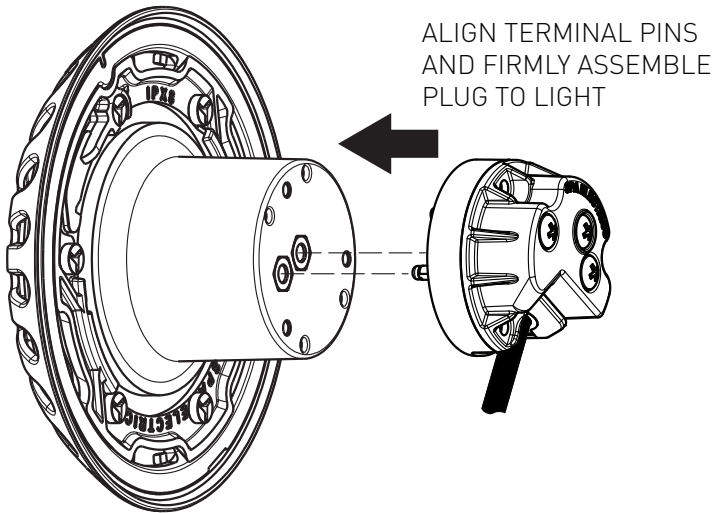

IMPORTANT NOTES

- DO NOT OVERTIGHTEN SCREWS
- DO NOT USE POWER-TOOLS
- DO NOT ADD SEALANTS, GREASES OR ADHESIVES
- ENSURE ALL SURFACES ARE CLEAN AND DRY
- **DO NOT ASSEMBLE UNDERWATER**

LIGHT ASSEMBLY

1

COIL CABLE INSIDE NICHE

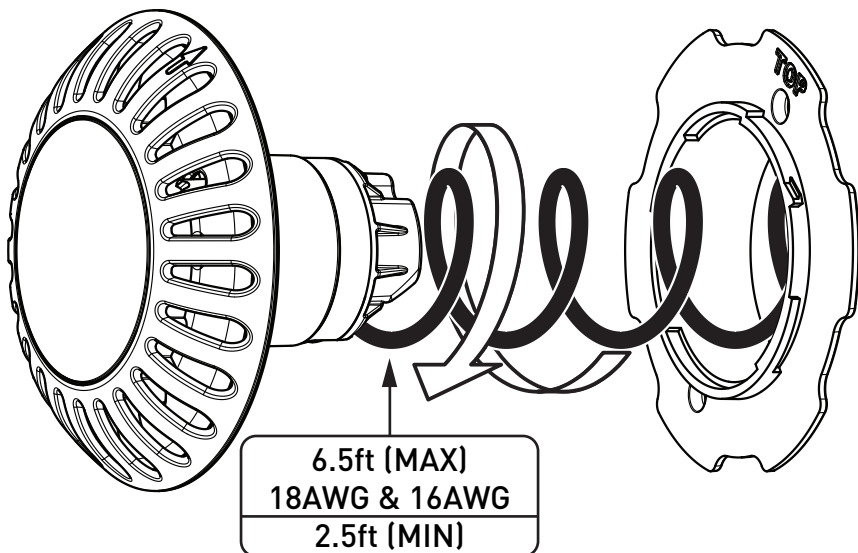

2

INSERT LIGHT INTO LOCKING RING

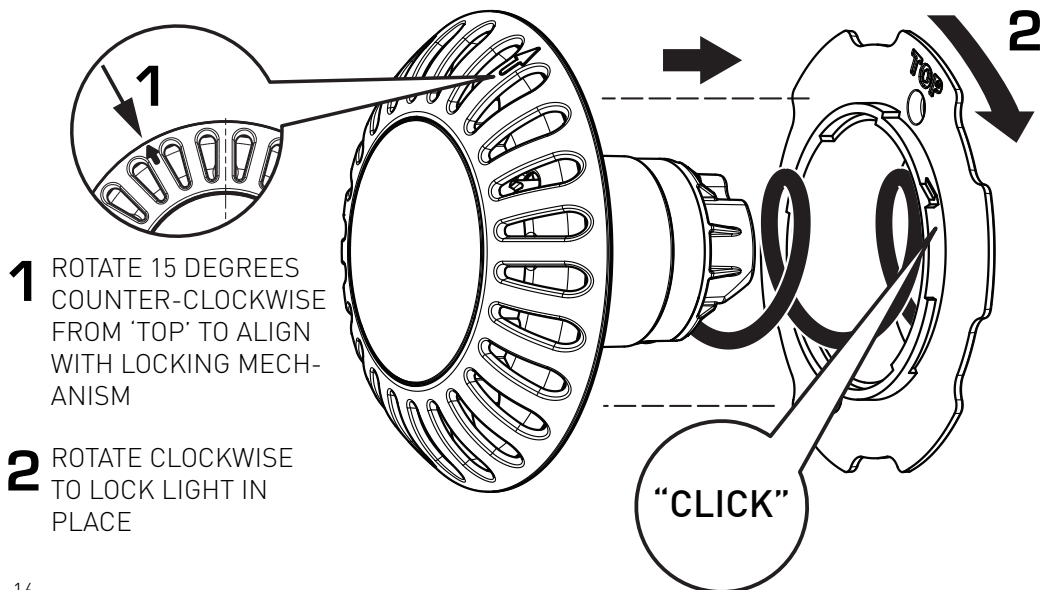

LIGHT REMOVAL

1

PUSH & HOLD BUTTON WITH FLAT BLADE

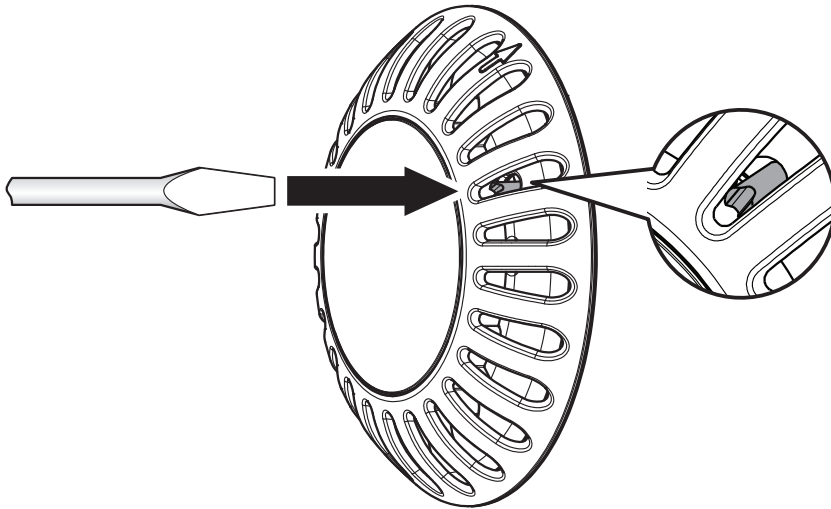

2

ROTATE COUNTER-CLOCKWISE & REMOVE FROM LOCKING RING

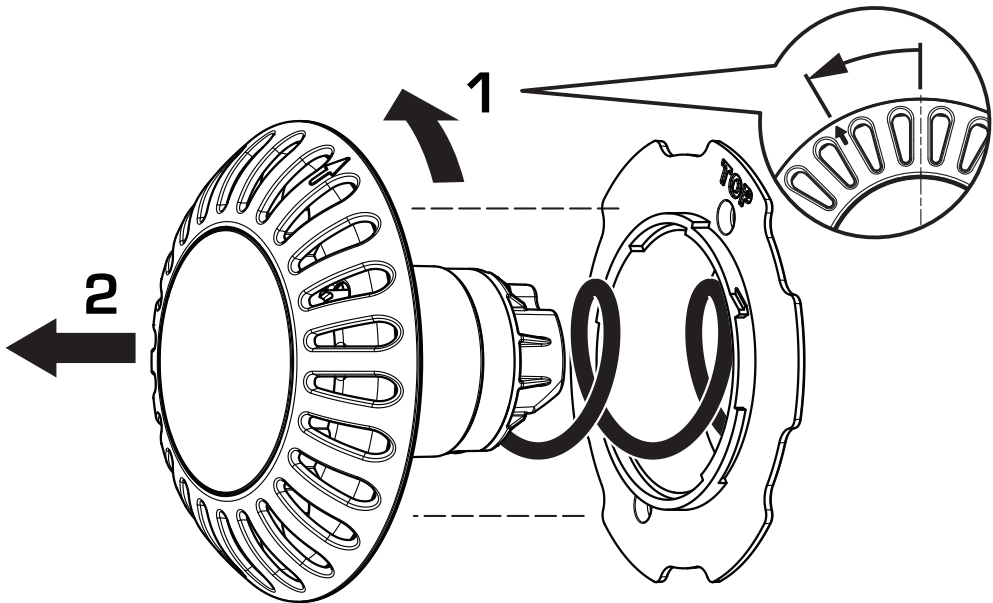

MULTI-COLOR OPERATION

1

STANDARD MODEL

Multi-Color light models provide a choice of 8 exciting fixed colors & 2 Multi-Color programs with the flick of a switch!

COLORS AVAILABLE:

- | | | |
|----------------------------|-------------------------|--------------------------|
| 1. Electric Blue | 4. Spring Lime | 7. Daylight White |
| 2. Midnight Magenta | 5. Lagoon Green | 8. Warm White |
| 3. Ruby Red | 6. Tropical Aqua | 9. Slow color Blend |
| | | 10. Fast Color Change |

OPERATING INSTRUCTIONS

1. To change the color of the light, simply turn your light **OFF** for **2** seconds and then turn it back **ON**. This will signal the light to step through to the next color. Colors will display in the order above, to select a desired color, simply step through the colors until you find your desired selection.
2. Your lights will automatically save your selected color once the power has been turned **OFF** for more than **1** minute so the next time the lights are used, they will illuminate on the last color selected.
3. To reset or '**synchronize**' your lights; with the power turned **ON**, turn the power **OFF/ON** once rapidly. This will put the lights into **RESET** mode (flashing **BLUE**), once this occurs turn the power **OFF**, wait **2** seconds & turn the power **ON**. Your lights should now be synchronized.

SYNCHRONIZED INSTALLATION

When installing multiple lights; to ensure synchronization and ease of operation all lights must operate from a single switch.

SUGGESTED WIRING DIAGRAM

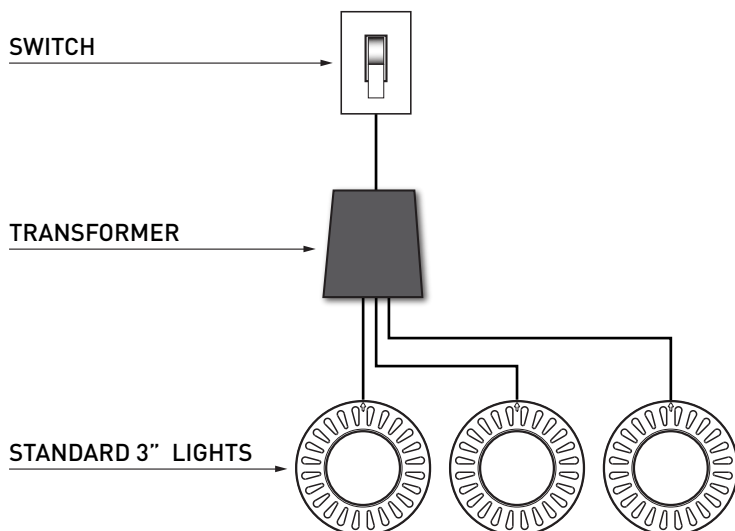

The ParaGlo 3" 'P-Type' lights integrate with the Pentair **EasyTouch®**, **IntelliTouch®** & Zodiac **Aqualink® RS OneTouch™** (Rev R - Current) Control systems. This allows the user to have direct control over colors and light shows via the intelligent control unit.

To setup the controller to operate the ParaGlo 3" 'P-Type' lights, simply follow the controller setup procedure and select "INTELLIBRITE" as the desired operating mode.

IMPORTANT:

The **ParaGlo 3"** light is **not** designed to be operated in conjunction with other manufacturers lighting products as the colors and shows may not be identical.

SUGGESTED WIRING DIAGRAM

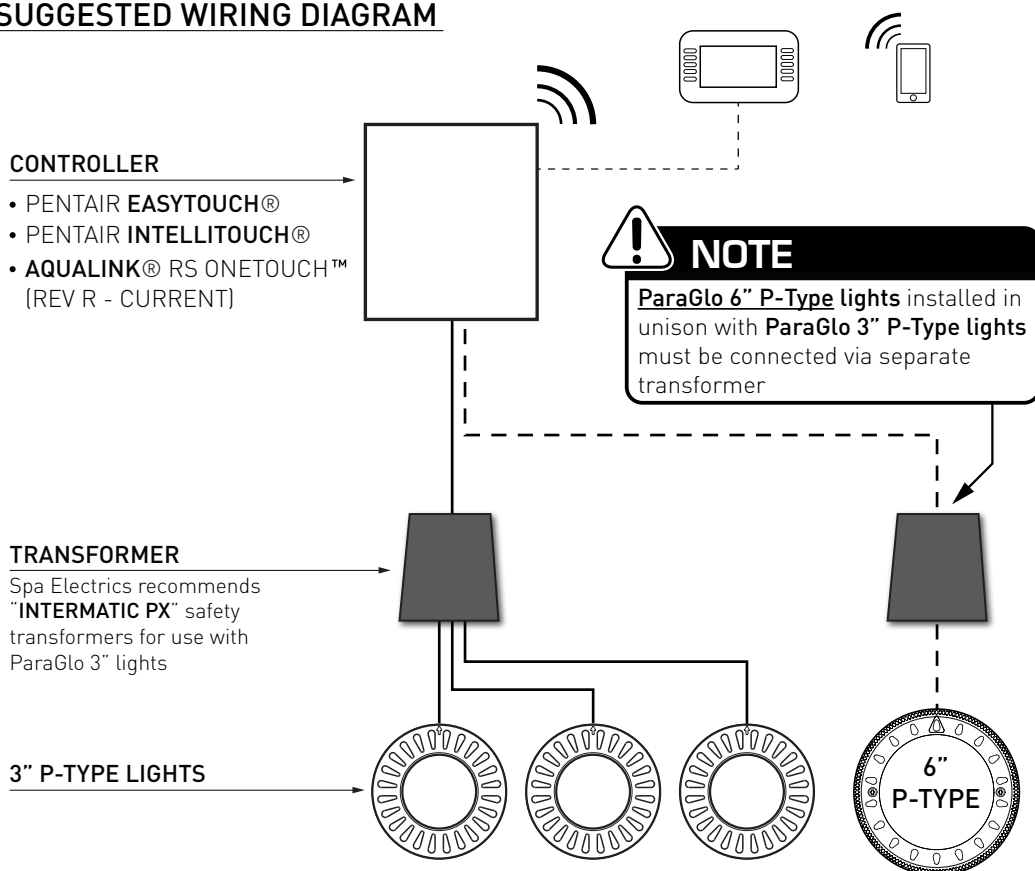

EASYTOUCH®, INTELLITOUCH® and SAM® are registered trademarks of Pentair Water Pool and Spa, Inc. and/or its affiliated companies in the United States and/or other countries. AQUALINK® is a registered trademark of Zodiac Pool Care, Inc.

If required, the **ParaGlo 3" 'P-Type'** lights can function using a standard wall switch. Wall switch operation can be used to select individual colors and shows as well as activate the 'HOLD' & 'RECALL' feature.

Turning the switch **OFF/ON** a specific number of times will select one of the five fixed colors or seven light shows available.

To select a different color show mode **[1-7]** or fixed color **[8-12]**, with the lights turned **ON** - Turn the wall switch **OFF/ON** the required number of times. Each number **[1-12]** below corresponds to the number of times to power cycle the switch to activate the selected show or fixed color.

NOTE: Whenever a different color mode is selected by the user, the light is turned off for a short period (a few seconds) until the new mode is activated. This is normal operating behaviour.

Number of times to cycle power [1-14]	1	SAM®:	Cycles through white, magenta, blue and green colors. (emulates the Pentair SAM® color changing light).
	2	Party:	Rapid color changing building energy and excitement.
	3	Romance:	Slow color transitions creating a mesmerizing and calming effect.
	4	Caribbean:	Transitions between a variety of blues and greens
	5	American:	Patriotic red, white and blue transition.
	6	California Sunset:	Dramatic transitions of orange, red and magenta tones.
	7	Royal:	Richer, deeper color tones
	8	Blue:	Fixed color.
	9	Green:	Fixed color.
	10	Red:	Fixed color.
	11	White:	Fixed color.
	12	Magenta:	Fixed color.
	13	Hold:	Save the current color effect during a color light show.
	14	Recall:	Activate the last saved color effect.

SUGGESTED WIRING DIAGRAM

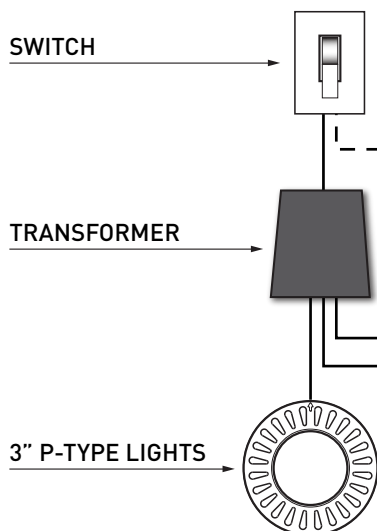

NOTE

ParaGlo 6" P-Type lights installed in unison with **ParaGlo 3" P-Type** lights must be connected via separate transformer

KEY DIMENSIONS

A

NICHE

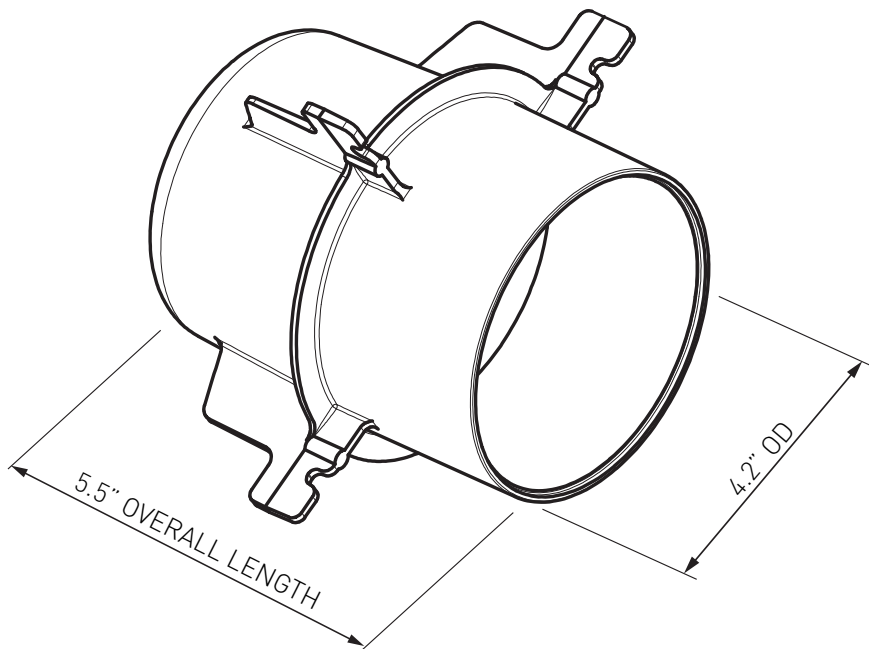

B

INSTALLED LIGHT

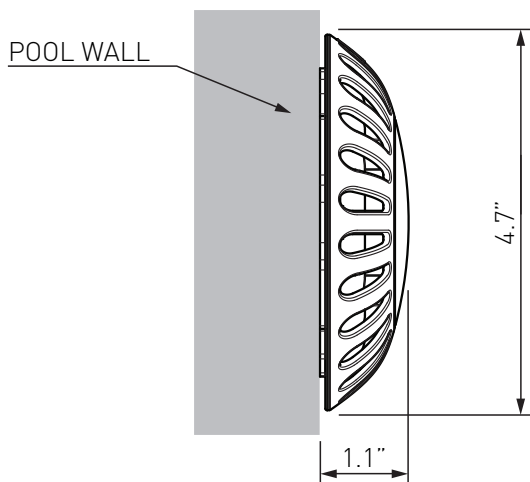

TROUBLESHOOTING

ISSUE	REASON	ACTION
Light flashing Blue continuously	System is in "Reset" mode	Refer to multi-color operating instructions
Light flashes 2 times	Light over heating	Check light is fully submerged. Check vents are not obstructed
Light flashes green	Over-voltage detected	Ensure transformer output voltage is between 12V ~ 13V. Replace transformer if necessary.
Light not operating (1)	Faulty connection to transformer	Ensure cable correctly connected to transformer terminals
Light not operating (2)	Mains power not connected	Check transformer is plugged in to GPO and switched on
Light not operating (3)	Damaged cable	Disconnect plug top and test voltage under load using multi-meter (ie. 20w 12v)
Light not operating (4)	Transformer not working	Check fuses & test transformer using multimeter under load (ie.15W 12V)
Light not operating (5)	Damage caused by high voltage and/or incorrect power supply.	Return product to Paramount Pool Systems for repair
Light colours not synchronized	Power interruptions or lights have been used individually	Reset lights - refer to multi-color operating instructions

**If these issues cannot be resolved
with the above recommended actions,
please contact Paramount Pool & Spa Systems AZ 85225.**

Phone: **TOLL FREE** 1800 621 5886 Email: paramount@1paramount.com
Web: www.1paramount.com

ELECTRICAL GROUNDING

Underwriters Laboratories (UL) Statement

Per the NEC, NFPA 70, Article 680.23 (B)(5), states that bonding shall not be required for luminaires that are listed for the application and have no non-current carrying metal parts. In addition, per Article 680.26 (B)(4), exception states that Listed low-voltage lighting systems with non-metallic forming shells shall not require bonding.

Therefore, luminaires that are located in the Class 2 circuit with polymeric/non-current carrying metal parts are not required to be grounded / bonded.

Manufacturers Statement

ParaGlo 3" & 6" (EM & WN9) luminaires with their plastic housing designs and plastic niches do not require grounding / bonding when operated within a Class 2 circuit supply.

ParaGlo 3" & 6" (EM & WN9) lights have also been determined to comply with the applicable requirements for wet-niche, LED type Swimming Pool and Spa Luminaires.

FCC COMPLIANCE STATEMENT

This device complies with part 15 of the FCC rules. Operation is subject to the following two (2) conditions:

- (1)** This device may not cause harmful interference, and
- (2)** this device must accept any interference received, including interference that may cause undesired operation.

Note: This equipment has been tested and found to comply with the limits for a Class B digital device, pursuant to part 15 of the FCC Rules. These limits are designed to provide reasonable protection against harmful interference in a residential installation. This equipment generates, uses and can radiate radio frequency energy and, if not installed and used in accordance with the instructions, may cause harmful interference to radio communications. However, there is no guarantee that interference will not occur in a particular installation. If this equipment does cause harmful interference to radio or television reception, which can be determined by turning the equipment off and on, the user is encouraged to try to correct the interference by one or more of the following measures:

- **Reorient or relocate the receiving antenna.**
- **Increase the separation between the equipment and receiver.**
- **Connect the equipment into an outlet on a circuit different to that to which the receiver is connected.**
- **Consult the dealer or an experienced radio / TV technician for help.**

Do not make any changes or modifications to the equipment unless otherwise specified in the manual.



NOTE

PLEASE STORE THIS
MANUAL IN A SAFE PLACE
FOR FUTURE REFERENCE



Powered by:

Paramount™

Pool Life. Simplified.



Proudly manufactured by

Spa Electrics



www.spaelectrics.com.au

© COPYRIGHT 2015 SPA ELECTRICS PTY. LTD.
ALL RIGHTS RESERVED

001-900-5900-00
REV (20150610)